

RECOMMENDED P.C. BOARD LAYOUT

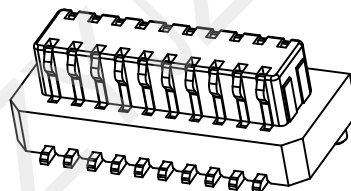

Specifications
 Current Rating:0.5Amp
 Insulation Resistance:500MΩMin.
 Dielectric Withstanding Voltage:200VA
 Contact Resistance:20mΩMax.
 Operating Temperature:-40°C to +105°C
 Materials
 Contact Material:Phosphor Bronze
 Insulator Material:High Temperature Thermoplastic, UL 94V-0 Nylon9T or the equivalent material

合高	H	H1
4.00H	2.80	1.80
4.50H	3.30	1.80
5.00H	3.80	1.80
5.50H	4.30	2.30
6.00H	4.80	2.30
6.50H	5.30	2.30
7.00H		

Circuits	排列	Dimensions(mm)			
		A	B	C	D
6	2*3	4.30	2.80	1.60	3.40
8	2*4	5.10	3.60	2.40	4.20
10	2*5	5.90	4.40	3.20	5.00
12	2*6	6.70	5.20	4.00	5.80
14	2*7	7.50	6.00	4.80	6.60
16	2*8	8.30	6.80	5.60	7.40
18	2*9	9.10	7.60	6.40	8.20
20	2*10	9.90	8.40	7.20	9.00
30	2*15	13.90	12.40	11.20	13.00
40	2*20	17.90	16.40	15.20	17.00
50	2*25	21.90	20.40	19.20	21.00



深圳市华宇创精密电子有限公司

TOLERANCE:

X.X ±0.30
 X.XX ±0.25
 X.XXX ±0.15
 X.' ±2' X.X' ±0.5'

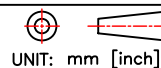

UNIT: mm [inch]

SCALE:1:1 SIZE: A4

DRAWN BY : 陈一鸣

DATE : 2014-02-23

PART NAME: 0.8PH 单槽BTB 公座

CHECKED BY: 马跃

DATE : 2014-02-23

PART NO. HYC36M-BTB2XN-XXX

APPROVED BY: 邱敏

DATE : 2014-02-23

MOLD NO.

DRAW NO: HYC-2304171143

SHEET NO. 1 OF 1